

JD Tech Online Graphics Program

Banner Stand Assembly Instruction Sheet

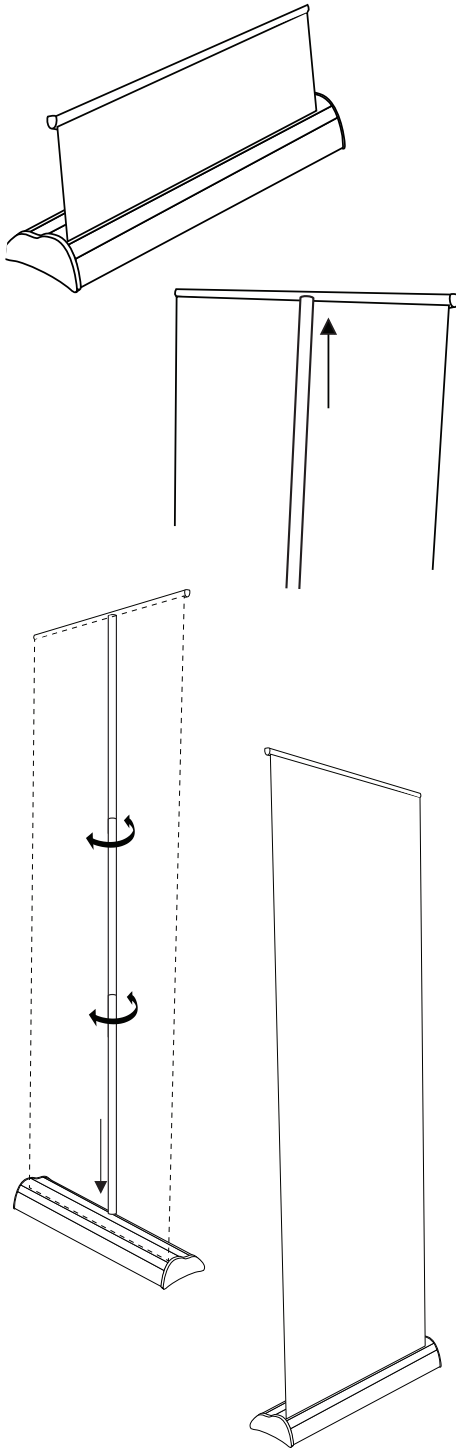

1. Banner is in base of display. Pole is either in bottom or side of base. Remove pole from base. Set the banner stand base flat on the floor and insert the telescoping support pole into designated support.

2. Pull the top of banner out of base and attach to telescoping pole. By twisting the support pole left to loosen, you can adjust the height of the pole to fit the banner. Tighten support pole by twisting right when at desired correct height.

3. When taking banner down, twist and loosen support pole, lower pole and banner. Unhook banner and carefully let it roll into base. Take out support pole and put back in base. (Tip: Do not let the banner roll into the base by itself too quickly. The edges will wear quicker.)